

# KWIB1811

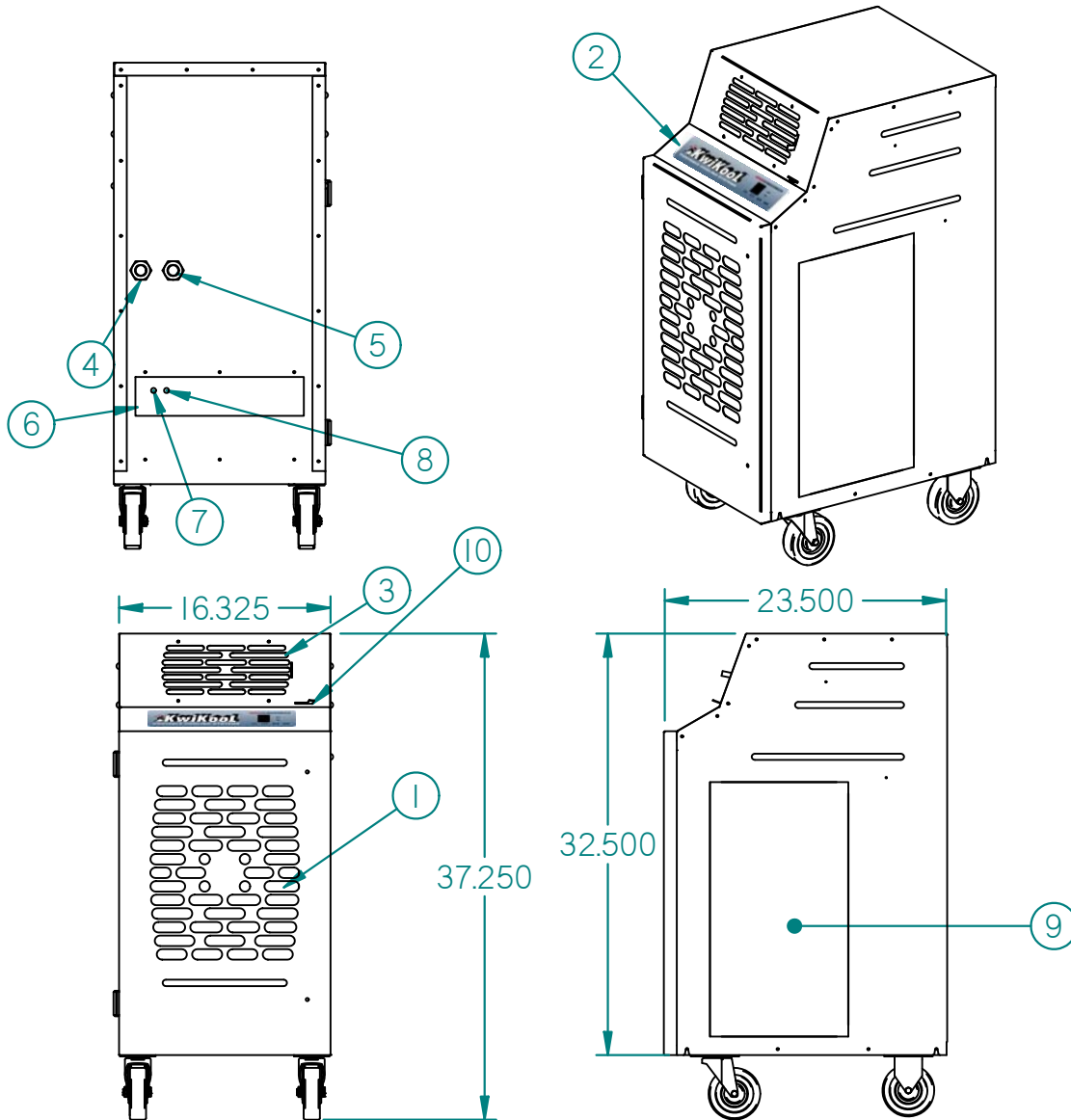

## LEGEND

- |                   |                         |
|-------------------|-------------------------|
| 1 Cold Air Return | 6 Power Cord            |
| 2 Control Pad     | 7 Condensate Nipple     |
| 3 Cold Air Supply | 8 Condensate Alarm Jack |
| 4 Water Inlet     | 9 Access Door           |
| 5 Water Outlet    | 10 Vent Control         |



# SPECIFICATIONS

# KWIB1811 - 1.5 Ton

| COOLING CAPACITY   |                                 |                          |
|--------------------|---------------------------------|--------------------------|
|                    | BTU/hr @ 95F at 60% RH          | 17,700 (1.5 Ton)         |
| COMPRESSOR DATA    |                                 |                          |
|                    | Compressor Type                 | Hermetic Rotary          |
|                    | Operating Temperatures          | 60-110 F 50%RH           |
|                    | Refrigerant                     | 421A                     |
| FAN DATA           |                                 |                          |
| Evaporator         |                                 |                          |
|                    | Fan Type (Centrifugal)          | Direct Drive             |
|                    | Air Flow (CFM)                  | 600/3 Speed              |
|                    | Supply Air Device               | Adjustable Vent          |
|                    | Supply Air Chute Kit (optional) | 2 - 5" Dia. x 12" Length |
| Water Flow Data    |                                 |                          |
|                    | Flow Regulation Valve           | Automatic                |
|                    | Inlet Water 85F-95F Exit (GPM)  | 4.5                      |
|                    | Inlet Water 75F-95F Exit (GPM)  | 2.25                     |
|                    | Inlet Water 65F-95F Exit (GPM)  | 1.5                      |
|                    | Inlet Water 55F-95F Exit (GPM)  | 1.2                      |
| ELECTRICAL DATA    |                                 |                          |
|                    | Power Supply (Volts)            | 115/Single Phase         |
|                    | Current Consumption (Amps)      | 16.5                     |
|                    | Power Consumption (KW)          | 1.6                      |
|                    | Maximum Circuit Breaker (Amps)  | 20                       |
|                    | Minimum Circuit Capacity(Amps)  | 16.75                    |
|                    | Min./Max. Voltage               | 105-125                  |
|                    | Power Cord Gauge/Length         | 12AWG/6'                 |
|                    | Plug Configuration              | NEMA 5-20                |
| DIMENSIONAL DATA   |                                 |                          |
|                    | Width x Depth x Height (Inches) | 16.325" x 23.5" x 37.25" |
|                    | Weight (Lbs.)                   | 151                      |
|                    | Shipping Weight (Lbs.)          | 226                      |
| SAFETY DEVICE DATA |                                 |                          |
|                    | Compressor Overload             | Internal                 |
|                    | Fan Motor Overload              | Automatic Internal       |
|                    | Evaporator Freeze Protection    | Hot Gas Bypass           |
|                    | High Pressure Switch            | Manual                   |
|                    | Low Pressure Switch             | Automatic                |
|                    | Compressor Short Cycle          | Yes                      |
|                    | Automatic Restart               | Yes                      |
|                    | Thermostat Type                 | Microprocessor/Digital   |
|                    | Condensate Pump Overflow        | Yes                      |
|                    | Condensate Tank Overflow        | Yes                      |

**1-800-KWIKOOL**